

Isotop® DZE-BL-4

Multi-part-element Stainless Steel
up to Load of 4000 kg

by getzner
isotop®

Design

Isotop® DZE-BL-4 is a solid element consisting of stainless steel (1.4301) and two different insulation materials Syلودyn® and Syلودamp®. Combined they are resilient to pressure and tensile loading. Due to the spring/damper combination the transmission of vibration can be isolated precisely and effectively and strong amplitudes will be debilitated. The continuous steel axis with its welded-on baseplate endures strong horizontal forces as well as massive negative impulses like e.g. windloads.

Field of application

Isotop® DZE-BL-4 elements can be adjusted individually down to a natural frequency of approx. 7 Hz depending on the load.

Various applications, for example elastic isolation of:

- Diesel-Engines
- Heavy Compressors
- Heavy Pumps
- Cooling towers
- Fast rotating machines
- Cogeneration units
- Roof-top devices
- Emergency power units
- Marine-Applications
- Mobile-Applications

Required data for selection

- Total weight to be absorbed
- Number and location of points of support
- Centre of gravity
- Structural shape of the device
- Direction of load
- Lowest disturbing frequency
(rotational speed or number of strokes)

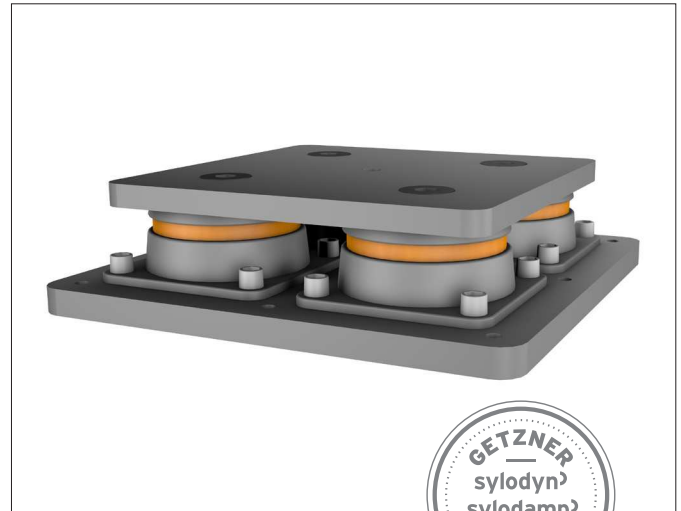

Isotop® DZE-BL-4

Advantages

- Different combinations of spring/damper elements depending on the load of the device allow ideal frequency tuning
- Premounted elements ensure fast assemblage
- Demolition-proof – especially advisable for narrow and tall devices or mobile applications
- Long durability
- Low resonant frequency
- Low construction height
- Best protection against corrosion

Our service

Make use of our know-how on questions about vibration technology. We will gladly consult you and will calculate tailor-made solutions for vibration isolation.

Selection table

DESCRIPTION	REF. NO.	MAX. LOAD IN KG	NATURAL FREQUENCY IN HZ ON MAX. LOAD	DEFLECTION IN MM
Single-layer				
Isotop® DZE-1-BL-4-xx/SP	on request	4,000	10.3	2.2
Doppellagig				
Isotop® DZE-2-BL-4-xx/SP	on request	3,800	7.2	4.4

Isotop® DZE-2-BL-4

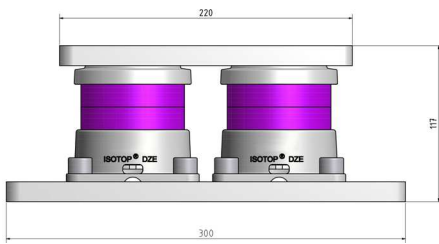

Isotop® DZE-1-4

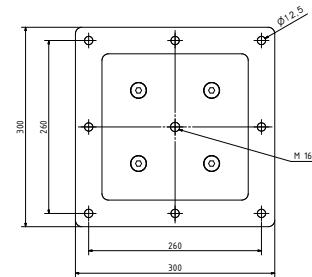
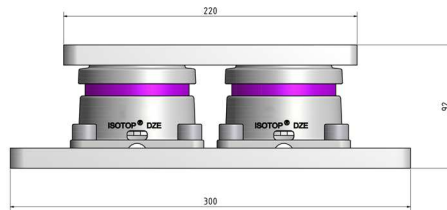

All data indicated are based upon our current knowledge. They may be used as calculation and standard values and are subject to the usual machining tolerances. Subject to change and correction.