

STAIR BEARING SB10

DATA SHEET

Product properties

Material	Elastomer: Sylomer® Filler: polyethylene
Colour	green
Range of use	Concrete stairs in residential, commercial and industrial buildings <ul style="list-style-type: none">• In-situ concrete stairs• Precast concrete stairs

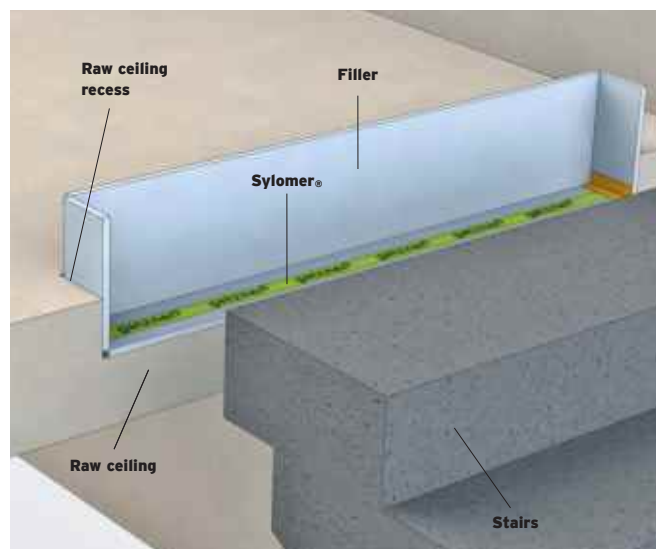

Improvement of impact noise 31dB

According to ISO 717-2

Product properties		Test methods	Comment
Static range of use (quasi-static loads)	$\leq 24 \text{ kN/m}$		
Maximum design load (loads at design level)	$\leq 75 \text{ kN/m}$		
Unladen bearing thickness	12 mm		
Bearing width	100 to 235 mm		
Delivery length	1,500 mm		
Flammability	Class E	EN ISO 11925-2	Normal flammable, EN 13501-1
Temperature range	-30 °C to +70 °C		Higher temperatures possible for short periods
Measured rate of impact noise reduction $\Delta L_{n,w,flight}$	31 dB	DIN 7396	ISO 717-2 Reference component rigid landing

Advantages and benefits

- Outstanding level of impact noise reduction at minimum installation height
- Highly effective across the entire load range
- Quick and easy installation
- Compensation of construction tolerances
- Defined load transmission and low deflection
- Aging stability extending over decades
- Flexible adjustments to the specified bearing dimensions

Impact noise improvement level according to DIN 7396

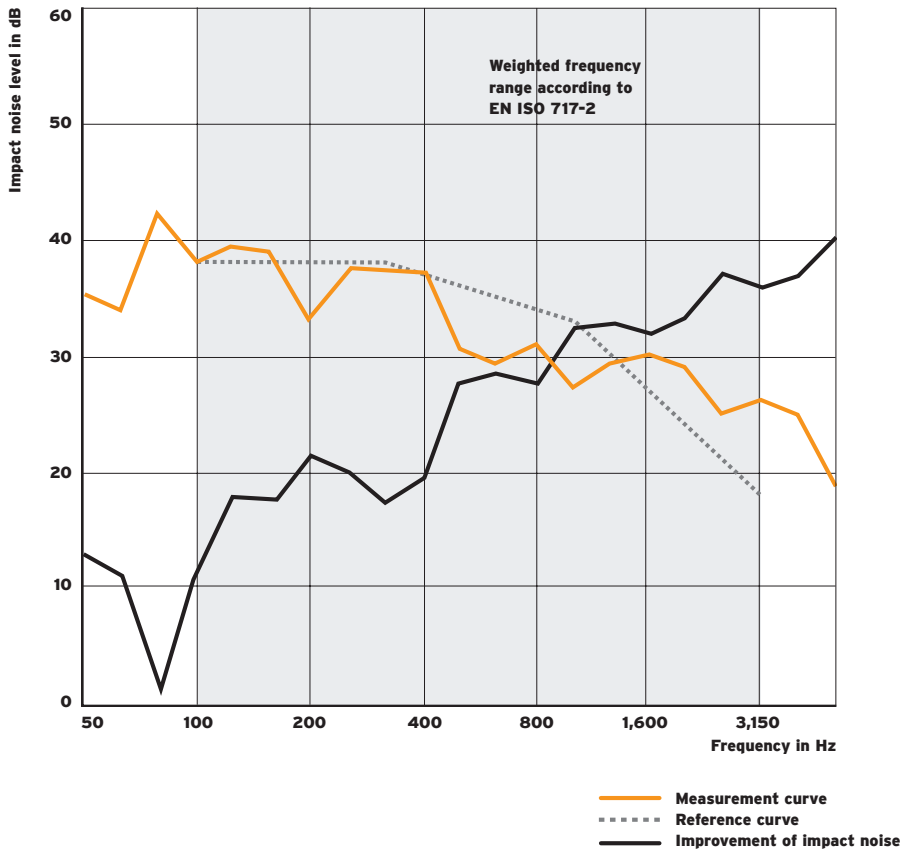

f in Hz	L_n in dB	$\Delta L_{n,w,flight}$
50	35.4	13.4
63	34.0	11.0
80	41.9	1.0
100	37.9	10.8
125	39.4	18.0
160	39.0	17.6
200	33.4	21.6
250	37.7	20.2
315	37.3	17.5
400	37.3	19.4
500	30.7	27.8
630	29.3	28.6
800	31.1	27.6
1,000	27.1	32.6
1,250	29.3	32.9
1,600	30.2	32.0
2,000	29.2	33.5
2,500	24.9	37.2
3,150	26.2	36.0
4,000	25.0	37.0
5,000	18.8	40.4

Experimental set-up

Precast stair flight with rigid landing
and elastically beared stair flight (4,400 kg)
12 mm Getzner SB10
240 mm partition wall (414 kg/m²)

Delivery forms

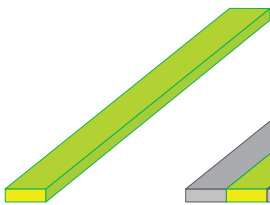

Type
SB10 S

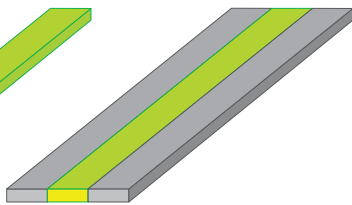

Type
SB10 I

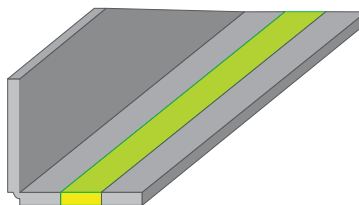

Type
SB10 L

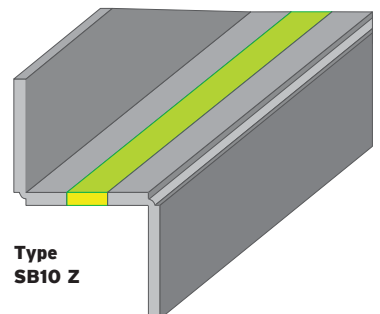

Type
SB10 Z

Further information



[getzner.com/
stair-bearing](https://getzner.com/stair-bearing)

All information and data is based on our current knowledge. The data can be applied for calculations and as guidelines, are subject to typical manufacturing tolerances and are not guaranteed. Material properties as well as their tolerances can vary depending on type of application or use and are available from Getzner on request.

Further information can be found in VDI Guideline 2062 (Association of German Engineers) as well as in glossary. Further characteristic values on request.